

SYSTEM

CWS 67 IW TT A type

NOTE.

사용 가능 유리

복층유리 : 22mm, 24mm, 28mm

삼중유리 : 32mm, 35mm, 43mm

진공유리 : 27.3mm, 31.3mm

열관류율

복층유리 : 1.74 Wm²/K

삼중유리 : 1.30 Wm²/K

진공유리 : 1.01 Wm²/K

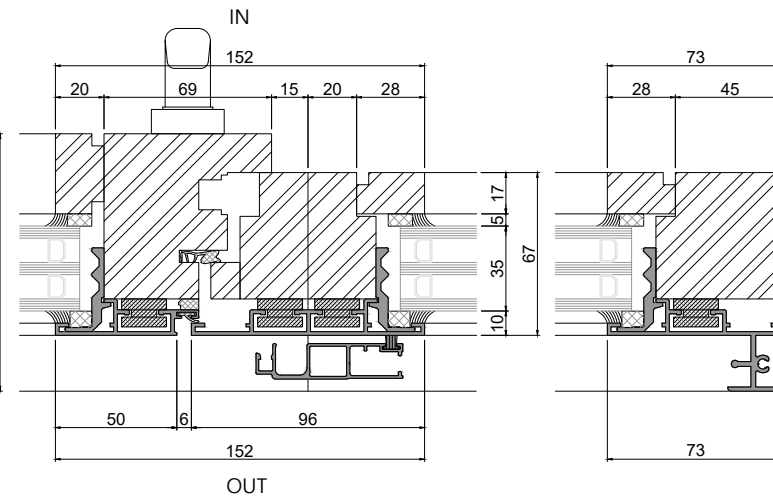
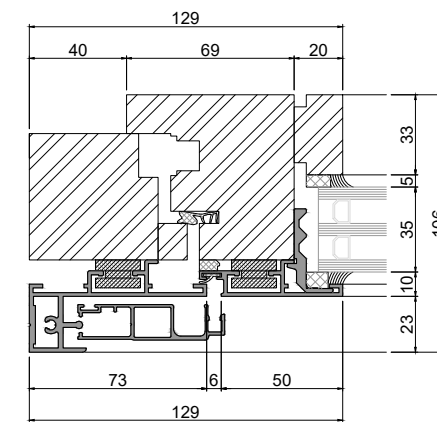
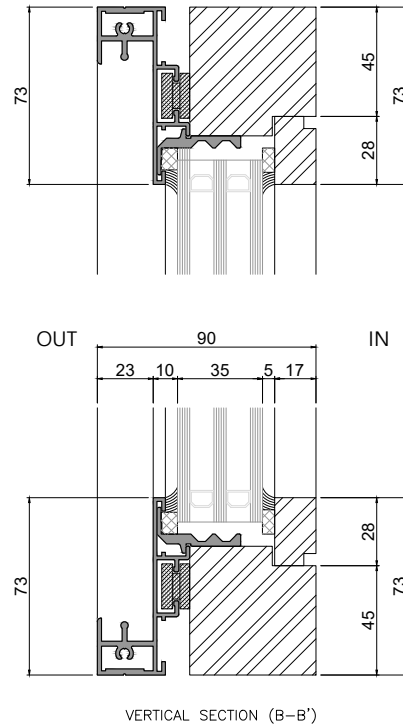
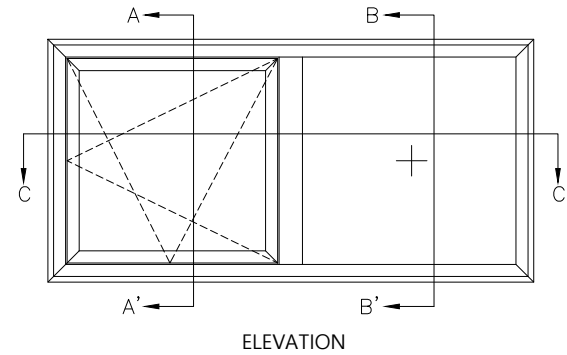

| REV. | DESCRIPTION | DATE |
|------|-------------|------|
| △ | | |
| △ | | |
| △ | | |
| △ | | |
| △ | | |
| △ | | |

CODE NO.

PROJECT TITLE

DRAWING NAME

DRAWING BY

CHECKED BY

APPROVED BY

FILE NAME

(주)이건창호
인천광역시 미추홀구 영전로 91 (도화동)
T 1522-1271 F (032) 760 0697